

TC25 and TC30 wifi RF receiver is designed to connect with wifi, then to control heating device as boiler, valves with voltage-free output.

Please adjust **RF-Optima W R2 PRO** parameter setting item 04 to 0 (Internal sensor only) when connect with TC25 or with TC30. TC25 version is without external sensor, TC30 is with external sensor.



Technical Data

| | |
|------------------------|------------------------------------|
| Operating Voltage: | 230Vac; 50/60Hz |
| Backup Storage: | EEPROM |
| Receiver Current Load: | Max 10A, voltage-free output NO/NC |
| External sensor: | TC25, no – TC30, yes |
| Dimensions: | 86mm x 86 mm x 26mm. |
| Color: | White |
| IP protection rating: | 20. |
| Certification: | CE, RoHS, RED |

Beware that when the sensor is not connected with TC30, the receiver turns off.

WIFI & RF Connection

TC25 – TC30 is designed to connect with wifi firstly then pair with thermostat. If TC25 already connected with wifi, by long press pairing button, it will enter RF connection mode with **RF-Optima W R2 PRO**.

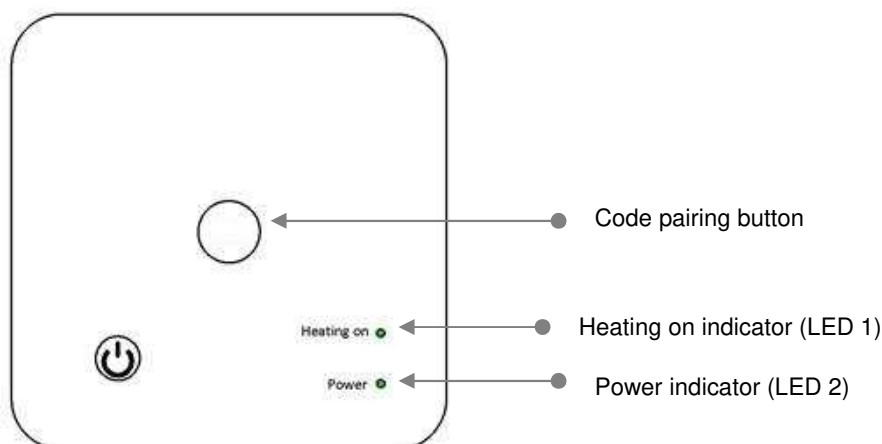

WIFI Code Pairing with APP :

1) Please download “Smart Life” APP from google play or app store.



- 2) Add device by press + button at top right corner
- 3) Press “ Small Home Appliances”
- 4) Find “ Thermostat” on the list and press to add device
- 5) Long press **Pairing button** on receiver to enter wifi connection mode, the LED 1 will flash quickly.
- 6) Press “Confirm indicator rapidly blink” on phone.
- 7) Wait a moment, when LED 1 on receiver stops flashing, wifi connection success.
If the LED still flash slowly, the connection fail, please try again from step. 5.

RF Code Pairing with RF-Optima W R2 PRO :

If more than one TCxx receiver will work with RF-Optima W R2 PRO, only one piece TCxx can enable wifi function, the other TCxx need to disable wifi function. Please follow below steps to pairing.

When TC25 – TC30 used enable WIFI function :

- 1) Turn on receiver, long press the **Coding button** on receiver until LED 1 is flickering quickly.
- 2) Turn off thermostat, and long press **SET** button until the code shows on the top left corner of screen, then press + button, the left corner battery icon start flashing.
- 3) Wait for a while, when LED 1 on receiver stop flickering, indicating successful code pairing.

When TC25 – TC30 used disable WIFI function:

- 1) Turn on receiver, long press the **Coding button** on receiver until LED 1 is flickering quickly.
- 2) Turn off thermostat, and long press **SET** button until the code shows on the top left corner of screen, then press **SET** button, the left corner battery icon start flashing.
- 3) Wait for a while, when LED 1 on receiver stop flickering, indicating successful code pairing.

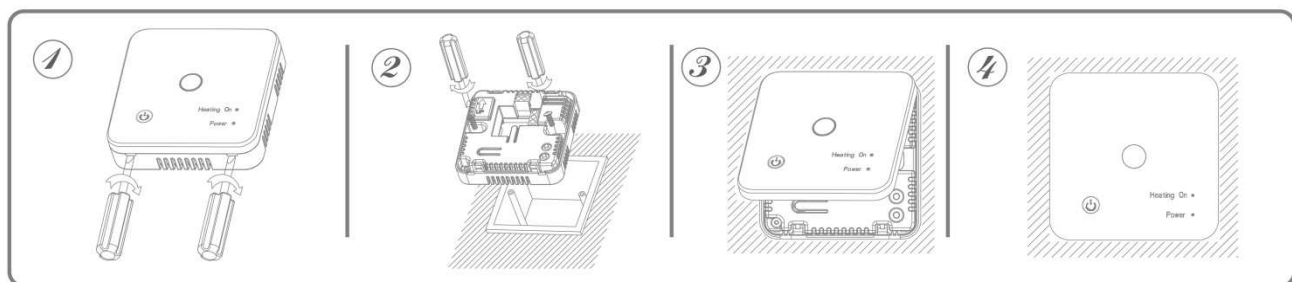
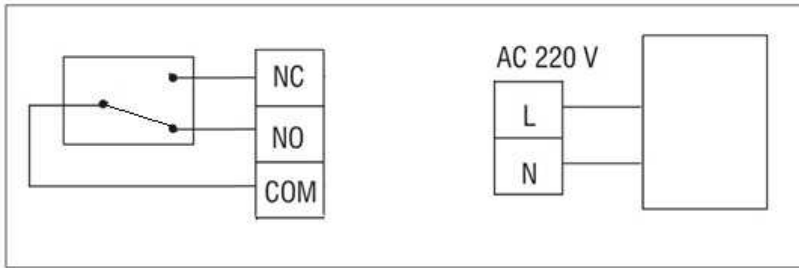
Wiring Diagram

Step 1: Using a small screwdriver, slightly loosen receiver cover plate.

Step 2: Terminate the thermostat as shown in the diagram

Step 3: Clip the front of the thermostat onto the back plate.